

Handy Guitar Lab for G6

Version 2.0

Operation Manual



This document cannot be displayed properly on black-and-white displays.

Contents

Introduction	3
Copyrights	3
Installing Handy Guitar Lab for G6.	3
Connecting to the G6.	4
How to control the G6 from the App	5
How to Edit Patch Memory from the App	6
Importing IRs	7

Introduction

Handy Guitar Lab for G6 is a remote control application specifically designed for the ZOOM G6 Multi-Effects Processor. Whether you are creating and editing patch memories, managing banks and patch memories or adjusting the system settings, this app allows you to operate a G6 from an iPhone. This manual does not explain the operation of the G6. See the G6 Operation Manual for detailed information about all its functions.

Accessibility for the Visually Impaired

The Handy Guitar Lab for G6 app supports iPhone VoiceOver and VoiceOver gestures. When VoiceOver is enabled in iPhone, users who are visually impaired can control the G6 Multi-Effects unit from the app.

Copyrights

iPhone is a trademark or registered trademark of Apple Inc. App Store is a service mark of Apple Inc. The Bluetooth® word mark and logo are registered trademarks of Bluetooth SIG, Inc., and these marks are used under license by Zoom Corporation. Product names, registered trademarks and company names in this document are the property of their respective companies. All trademarks and registered trademarks in this document are for identification purposes only and are not intended to infringe on the copyrights of their respective owners.

Installing Handy Guitar Lab for G6

1. Open the App Store on the iPhone and search for "Handy Guitar Lab for G6".

2. Tap "GET" on the Handy Guitar lab for G6 screen.

This will install Handy Guitar lab for G6 on the device.



NOTE

- When you launch Handy Guitar Lab for G6, you must connect it to the G6 so that it will operate. (→ "Connecting to the G6" on page 4).

Connecting to the G6

NOTE

- A separate ZOOM BTA-1 Bluetooth adapter must be installed in the G6 to remotely control it from an iPhone.



1. Turn on the G6.

2. Tap the Handy Guitar Lab for G6 app icon.

Handy Guitar Lab for G6 will launch.

3. The Bluetooth MIDI Devices List will appear when it is launched. To open the Bluetooth Device list tap the G6 button in the toolbar.



A: DIRECT 1 - 001KramRock



4. Tap the Device Name/ID to connect.

The G6 icon in the tool bar changes to blue when the app is connected to the G6.



Not connected



Connected

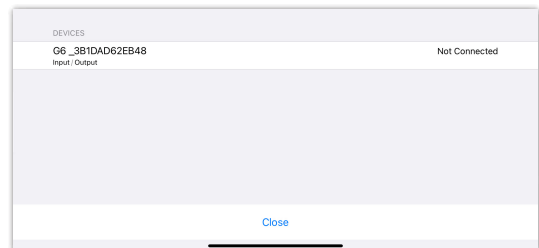

5. The G6 and Handy Guitar Lab will briefly sync up.



G6

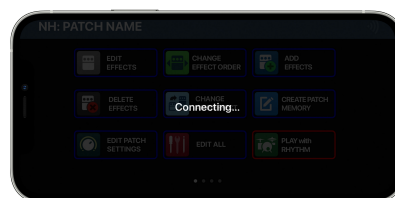

Handy Guitar Lab for G6

NOTE

- If connection is not successful, move the iPhone closer to the G6 or move both to a place where nothing interferes with radio waves and try connecting again. Confirm also that the Bluetooth function of the iPhone can be used.

How to control the G6 from the App

Once the App is connected to the G6, you can completely control the device from it. For example, you can select different patch memories, create and edit tones, manage banks and patches, adjust system settings, import and manage Impulse Responses and more.

To make it easy, the App UI matches the G6 UI. Here is the Playmode Effect Board Screen on the G6 and the App:



G6



Handy Guitar Lab for G6

Any changes on one device are immediately reflected on the other.

You can also display screens independently on each device to expand your capabilities. In the example below, you can control the Looper on the G6 and change patch memories within a bank in the App.



G6



Handy Guitar Lab for G6

NOTE



Please refer to G6 Operation Manual for details. The Operation Manual can be downloaded from the ZOOM website (www.zoom.jp/docs/g6).

How to Edit Patch Memory from the App

The EDIT ALL screen gives you the ability to edit all aspects of the Patch Memory from a single screen.

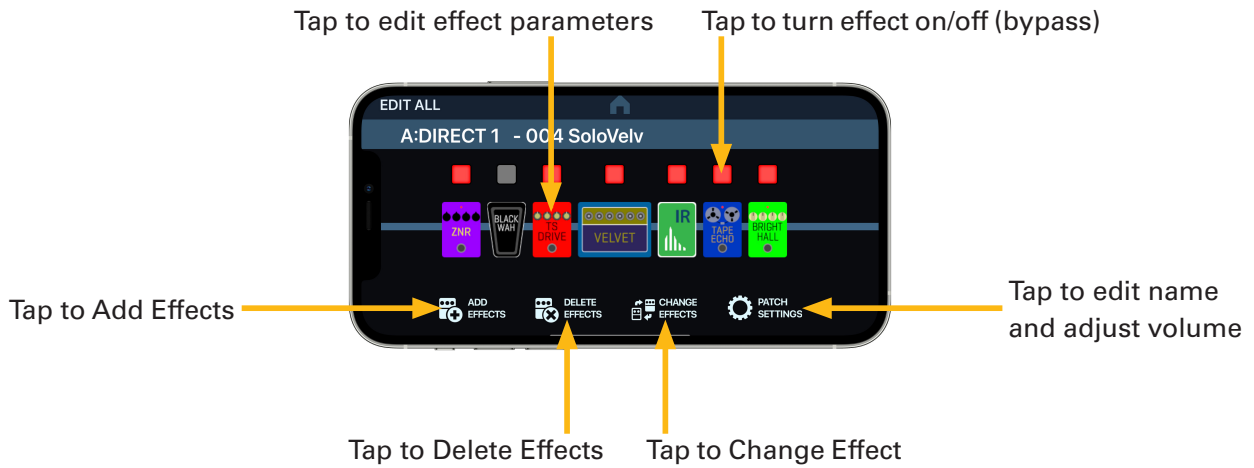

NOTE

To change effect order from the Handy Guitar Lab for G6:

1. Tap and Hold an effect icon.
2. Drag an effect icon to move it to the desired position.



Importing IRs

Importing IRs from Handy Guitar Lab for G6 allows you to quickly access IRs from locations on your iPhone like Dropbox, iCloud or the local file system.

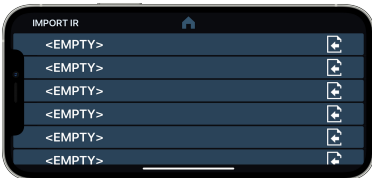

1. Tap  to open the IMPORT IR Screen.

2. Tap  on the slot where you would like to import the IR.

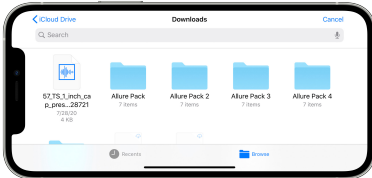

3. Use the browser to locate the IR on your device. Select the IR.

4. The EDIT NAME screen will appear.





5. Edit the name.

6. Tap OK. The IR will be transferred to the device.

NOTE

To edit the locations that appear in the IMPORT IR browser:

1. In iPhone, open the Files app 
2. Tap  then select Edit from the pop up.
3. Tap the slider to select the locations.
4. Tap "Done."

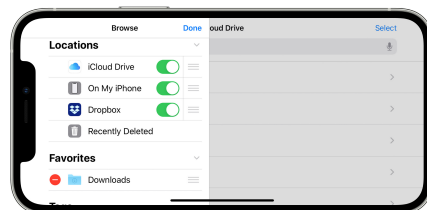



ZOOM CORPORATION

4-4-3 Kanda-surugadai, Chiyoda-ku, Tokyo 101-0062 Japan
zoomcorp.com

Z2I-4223-02